



Introducing
STARMARK[®]
C A B I N E T R Y



the beauty
is inside and out



THESE TWO PAGES
Alexandria and Lafontaine inset door styles in Maple finished in White |
Island cabinets created with the Alexandria inset door style in Maple finished
in Black | Shown in beaded inset with optional five-piece drawer headers

COVER
Edgemore door style in Maple finished in Bottle Green | Island cabinets
created with the Edgemore door style in Oak finished in Tarragon |
Shown with optional five-piece drawer headers

Thousands of colors in 7

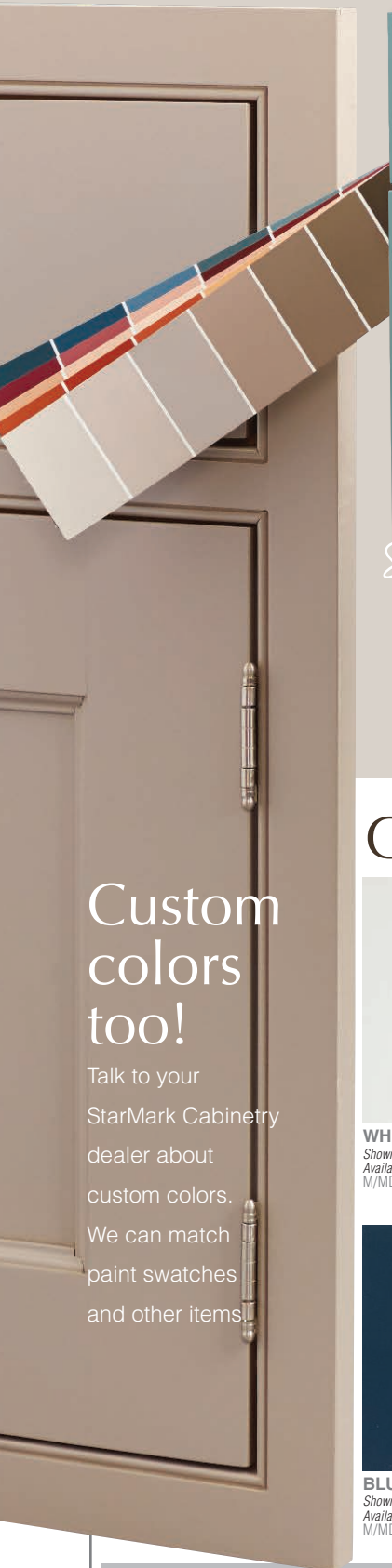

showstopping

BLUE

including Breeze with Chocolate glaze, shown here on the Taft door style in Maple



handsome

BROWN

including Hazelnut with Ebony glaze, shown here on the Cosmopolitan door style in Alder



energetic

RED

including Chateaux Brittany, shown here on the Lehigh door style in Cherry



elemental

GRAY

including Frost shown here on the Waynesville door style in Maple

Our most popular colors

Custom colors too!

Talk to your StarMark Cabinetry dealer about custom colors. We can match paint swatches and other items.



#1

WHITE

Shown above on Maple
Available in these wood types: M/MDF/O/Q



#2

MARSHMALLOW CREAM

Shown above on Maple
Available in these wood types: M/MDF/O/Q

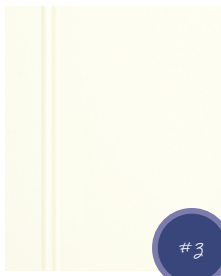

#3

SIMPLY WHITE

Shown above on Maple
Available in these wood types: M/MDF/O/Q

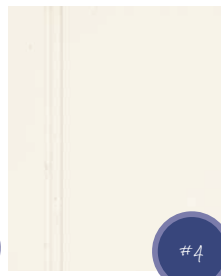

#4

DOVE

Shown above on Oak
Available in these wood types: M/MDF/O/Q

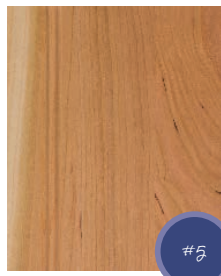

#5

NATURAL

Shown above on Cherry
Available in these wood types: A/C/H/M/O/Q/ΔA/ΔH/W



#6

BLUEBERRY

Shown above on Maple
Available in these wood types: M/MDF/O/Q

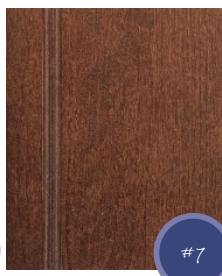

#7

CAPPUCCINO

Shown above on Cherry
Available in these wood types: A/C/H/M/O/Q/ΔA/ΔH/W



#8

WINGS

Shown above on Maple
Available in these wood types: M/MDF/O/Q

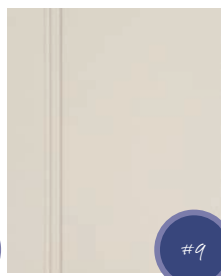

#9

REPOSE GREY

Shown above on Maple
Available in these wood types: M/MDF/O/Q

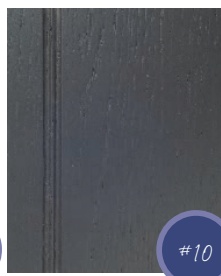

#10

PEPPERCORN

Shown above on Oak
Available in these wood types: M/MDF/O/Q

KEY TO WOOD TYPES

A Alder | C Cherry | H Hickory | M Maple | MDF Medium Density Fiberboard | O Oak | Q Quarter Sawn Oak
ΔA Rustic Alder | ΔH Rustic Hickory | W Walnut

color families



soothing

GREEN
including Sage, shown here on the Renwick door style in Maple

sophisticated

BLACK
including Villa Black, shown here on the Waynesville door style in Maple



best seller

WHITE | OFF WHITE
including Dove, shown here on the Montico inset door style in Maple



ABOVE Montico inset door style in Maple finished in White and in Graphite with optional five-piece drawer headers

With over 1,000,000 combinations of colors, wood types and door styles, StarMark Cabinetry provides the choices you need to express your style. And, we have all the popular techniques that add a vintage look.

- Chain Distressing
- Rounded Corners
- Chiseling
- Speckling
- Dips
- Spattering
- Knife Cuts
- Worm holes
- Rasping
- Worn edges

We have your style covered with over 115 door styles in six style families.

Door styles from each style family are shown here. To view our entire collection, visit your StarMark Cabinetry dealer's showroom and ask for the *Colors, Styles & Accents* brochure.

CONTEMPORARY

Including the Clifton, Tempo and Ventura door styles shown below.

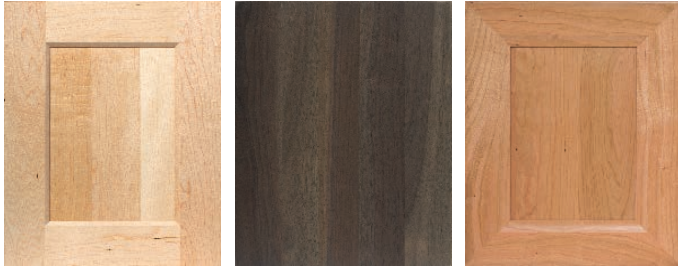

CLIFTON

Available in these wood types: A/C/H/M/O/ΔA

TEMPO

Available in these wood types: A/C/H/M/O/Q/W

VENTURA

Available in these wood types: A/C/H/M/O/Q/ΔA

COTTAGE/FARMHOUSE

Including the Huntingford, Lafayette and Xavier door styles shown below.



HUNTINGFORD

Available in these wood types: A/C/H/M/O

LAFAYETTE INSET

Available in these wood types: A/C/M/Q/ΔA

XAVIER

Available in these wood types: A/C/H/M/O/Q/ΔA/ΔH

ORNATE

Including the Bell Gardens, Gallant and Peabody door styles shown below.



BELL GARDENS

Available in these wood types: A/C/M/ΔA

GALLANT

Available in these wood types: C/M

PEABODY

Available in these wood types: A/C/M/ΔA

SHAKER

Including the Bonita, Fullerton and Milan door styles shown below.

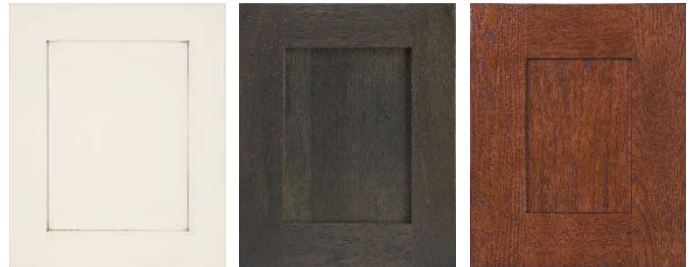

BONITA

Available in these wood types: A/C/H/M/O/ΔA

FULLERTON

Available in these wood types: A/C/H/M/O/ΔA/ΔH/W

MILAN

Available in these wood types: A/C/H/M/O/ΔA/W

TRADITIONAL

Including the Accord, Breckenridge and Venice door styles shown below.



ACCORD

Available in these wood types: A/C/H/M/O/ΔA/ΔH/W

BRECKENRIDGE

Available in these wood types: A/C/H/M/O/ΔA/ΔH/W

VENICE

Available in these wood types: A/C/H/M/O/ΔA/W

TRANSITIONAL

Including the Hanover, Tipton and Waterfall door styles shown below.

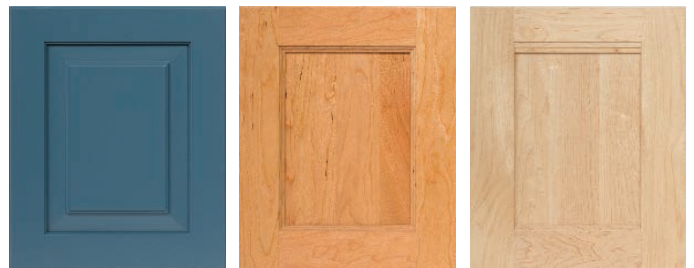

HANOVER

Available in these wood types: A/C/H/M/O/ΔA/W

TIPTON

Available in these wood types: A/C/H/M/O/ΔA

WATERFALL

Available in these wood types: A/C/H/M/O/ΔA

KEY TO WOOD TYPES

A Alder | C Cherry | H Hickory | M Maple | MDF Medium Density Fiberboard | O Oak | Q Quarter Sawn Oak
ΔA Rustic Alder | ΔH Rustic Hickory | W Walnut

Our most popular door styles



BRIDGEPORT
Available in these wood types:
A/C/H/M/O/Q/ΔA/W

STRATFORD
Available in these wood types:
A/C/H/M/O/ΔA/W

COSMOPOLITAN
Available in these wood types:
A/C/H/M/O/Q/ΔA/W

ROSEVILLE
Available in these wood types:
A/C/H/M/O/ΔA/W

FARMINGTON
Available in these wood types:
A/C/H/M/O/Q/ΔA/W



CHARLOTTE INSET
Available in these wood types:
A/C/M/Q/ΔA/W

LAFONTAINE INSET
Available in these wood types:
A/C/M/Q/ΔA/W

GILLETTE INSET
Available in these wood types:
A/C/M/Q/ΔA/W

FULLERTON
Available in these wood types:
A/C/H/M/O/ΔA/ΔH/W

RIDGEVILLE
Available in these wood types:
A/C/H/M/O/ΔA/W

Our newest door styles

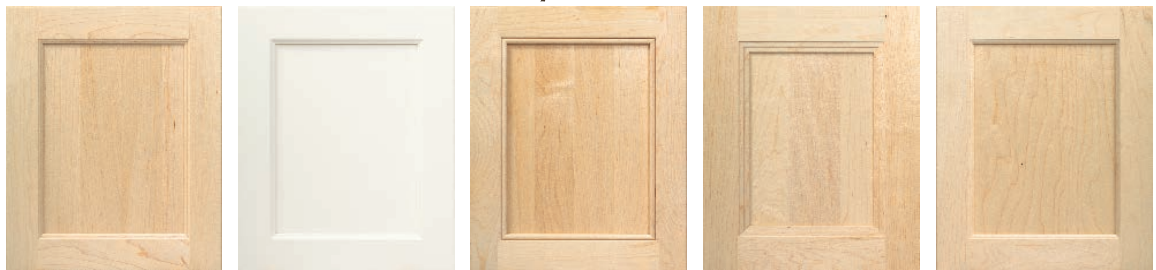

ABILENE
Available in these wood types:
A/C/H/M/O/Q/ΔA

ANITA
Available in these wood types:
A/C/H/M/O/Q/ΔA

BELFONTE
Available in these wood types:
A/C/H/M/O/Q/ΔA

CHAPPELL
Available in these wood types:
A/C/H/M/O/Q/ΔA

EDGEMORE
Available in these wood types:
A/C/H/M/O/Q/ΔA

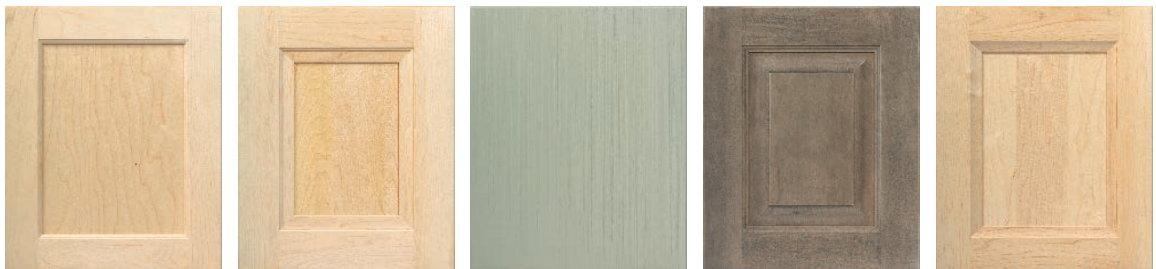

EDINBURGH
Available in these wood types:
A/C/H/M/O/Q/ΔA

REMINGTON
Available in these wood types:
A/C/H/M/O/Q/ΔA

TAMA
Available in these wood types:
MDF

TUCSON
Available in these wood types:
A/C/H/M/O/ΔA

VAIL
Available in these wood types:
A/C/H/M/O/Q/ΔA

To see all available door styles, wood types and colors, visit your StarMark Cabinetry dealer's showroom and ask for the *Colors, Styles & Accents* brochure. View your cabinet options here too: www.starmarkcabinetry.com

Lafontaine inset door style in Maple finished in Marshmallow Cream with optional five-piece drawer headers

organize & store



There's much, much more! Visit your StarMark Cabinetry dealer's showroom and ask for the *Organize & Store* brochure. It's an 84-page wish book for neatniks!



RESIN DECORATIVE PANEL

exactly what you want

accents & style

Most doors and drawers can be personalized with mullions, decorative panels and much more. Just a tiny sampling of the options available are illustrated here. There are hundreds more, so be sure to ask about your options to make your cabinetry all yours!



DECORATIVE STORAGE



MULLION DOORS



WALNUT DRAWERS



GLASS DOOR INSERTS



THE FIVE-PIECE HEADER IS JUST ONE WAY TO DRESS UP YOUR CABINETRY DRAWERS.

To see all the available door styles, wood types, colors, distressing techniques and accents, visit your StarMark Cabinetry dealer's showroom and ask for the *Colors, Styles & Accents* brochure. All options are also on www.starmarkcabinetry.com





CLOCKWISE FROM TOP LEFT
 Tabor door style in Cherry finished in Cappuccino
 Milan door style in Alder finished in Hazelnut with Ebony glaze
 Tempo door style in Quarter Sawn Oak finished
 in Repose Grey with Chocolate glaze



function and beauty for
your entire home

ABOVE Hudson door style in Oak finished in Java

INSET
CONSTRUCTION

StarMark Cabinetry Construction Details

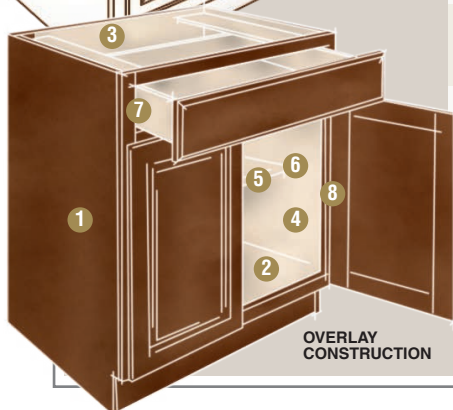
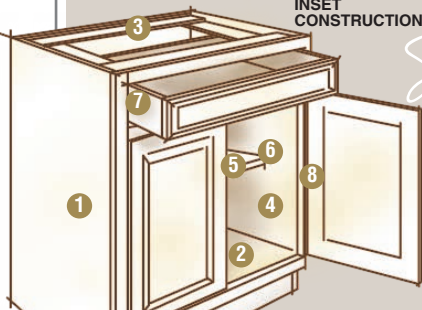

OVERLAY
CONSTRUCTION

		Overlay Construction	Inset Construction
1.	End (side) Panels <i>Several options, including</i>	3/4" hardwood plywood veneer core-unfinished <i>Finished, Flush, Furniture, Beaded, Decorator</i>	3/4" hardwood plywood veneer core-unfinished <i>Finished, Flush, Beaded, Furniture</i>
2.	Tops & Bottoms	1/2" hardwood plywood veneer core	1/2" hardwood plywood veneer core
3.	Back Panels <i>option</i> <i>option</i>	1/4" hardwood plywood <i>3/8" beaded back</i> <i>3/4" flush back</i>	1/2" hardwood plywood <i>3/8" beaded back</i> <i>3/4" flush back</i>
4.	Interiors <i>option</i> <i>option</i>	Natural birch melamine <i>Finished matching veneer</i> <i>Maple natural veneer</i>	Natural birch melamine <i>Finished matching veneer</i> <i>Maple natural veneer</i>
5.	Shelves	3/4" hardwood plywood	3/4" hardwood plywood
6.	Base Cabinet Shelves <i>option</i>	Two thirds deep <i>Full depth</i>	Two thirds deep <i>Full depth</i>
7.	Drawers & Rolls Trays <i>Glides</i> <i>option</i>	5/8" hardwood, dovetail joinery <i>Soft close, full extension, undermount, 100 lb. capacity</i> <i>Walnut drawer boxes and roll trays</i>	5/8" hardwood, dovetail joinery <i>Soft close, full extension, undermount, 100 lb. capacity</i> <i>Walnut drawer boxes and roll trays</i>
8.	Door closure	Adjustable soft close hinges	Choose from finial hinge in five colors or concealed hinge with soft close mechanism



ABOVE Tipton door style in Cherry finished in Carbon

STARMARK[®] CABINETY

600 East 48th Street North • Sioux Falls, SD 57104
www.starmarkcabinetry.com

This brochure is item #1570 and is called the "Getting Started" brochure.
© 2022 StarMark Cabinetry



www.facebook.com/starmarkcabinetry
www.pinterest.com/starmarkcabinet/
www.youtube.com/user/starmarkcabinet
www.houzz.com/pro/starmarkcabinetry/starmark-cabinetry
www.instagram.com/starmarkcabinetry/
Send questions to inquire@starmarkcabinetry.com



Part of the
MasterBrand[®]
Family



National Forest
Foundation



American Craftsmanship
Manufactured in Sioux Falls, South Dakota
from domestic and global components.



StarMark Cabinetry is ESP certified.
Kitchen Cabinet Manufacturers Association
Environmental Stewardship Program
All products impact the environment.
For ESP program criteria, visit kcma.org.

This brochure was printed in May 2022.

Accuracy of all reprinted color is subject to printing limitations.
Please bear in mind that variation is inherent in wood, and actual finishes may differ
substantially from what you see here.

As we continually seek to improve materials and production methods,
StarMark Cabinetry reserves the right to change specifications,
offerings or designs without notice.

DESIGN CREDITS

PAGES 2-3 This kitchen was designed by Kari Swift, of Kari Swift Designs, Spokane,
WA. The StarMark Cabinetry dealer for this project was Mike Poss of
Shapes Supply, a StarMark Cabinetry dealer in Arlington Heights, IL.

PAGE 5 This kitchen was designed by Christy Dunlap, a designer on staff at
Jennings Builders Supply, a StarMark Cabinetry dealer in Fletcher, North Carolina.
Photography by Meechan Architectural Photography.

PAGE 7 The kitchen cabinetry was designed by Kitchen Intuitions,
a StarMark Cabinetry dealer in Chatham, New Jersey.

PAGE 11 This home office cabinetry was designed by Heather Riediger, CKD,
a designer on staff at StarMark Cabinetry.